



Chingford Road, Walthamstow, London

A classic two bedroom ground floor Warner flat just a short stroll away from Lloyd park.

With its own private front door and attractive brick frontage, the property opens into two generous double bedrooms positioned at the front of the home, both offering excellent space and natural light. Moving through, you'll find a beautifully finished bathroom featuring a stylish mosaic tiled floor, crisp white metro wall tiles, ample built-in storage, and a shower over the bath.

The well-presented kitchen sits at the heart of the home, boasting stripped wooden flooring, a range of eye and base level units, solid wooden worktops, and a breakfast bar—perfect for casual dining as well as direct access to the garden.

To the rear, a bright and airy lounge overlooks the garden, creating a relaxing and inviting living space filled with natural light.

Outside, the west-facing rear garden is shared with the upstairs flat and offers a lovely mix of decking and lawn—ideal for enjoying afternoon and evening sun.

- Two Bedroom Ground Floor Flat
- Private Rear Garden
- 1.2 Miles To Walthamstow Central
- Walking Distance To Lloyd Park
- Easy Access To North Circular
- Council Tax Band B
- 738 Sq Ft (68.3 SQ M)
- Warner Flat

£450,000

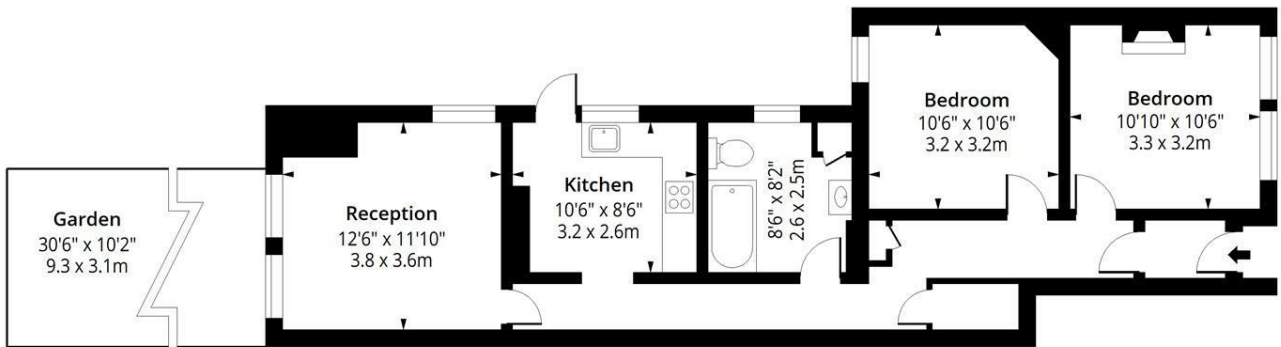

Ground Floor
Floor Area 735 Sq Ft - 68.28 Sq M

Chingford Road E17
Approx. Gross Internal Area
735 Sq Ft - 68.28 Sq M



Measured according to RICS IPMS2. Floor plan is for illustrative purposes only and is not to scale. Every attempt has been made to ensure the accuracy of the floor plan shown, however all measurements, fixtures, fittings and data shown are an approximate interpretation for illustrative purposes only. 1 sq m = 10.76 sq feet.

lpaplus.com



Energy Efficiency Rating		Current	Potential
Very energy efficient - lower running costs			
(92 plus) A			
(81-91) B			
(69-80) C			
(55-68) D			
(39-54) E			
(21-38) F			
(1-20) G			
Not energy efficient - higher running costs			
England & Wales	EU Directive 2002/91/EC		

Environmental Impact (CO ₂) Rating		Current	Potential
Very environmentally friendly - lower CO ₂ emissions			
(92 plus) A			
(81-91) B			
(69-80) C			
(55-68) D			
(39-54) E			
(21-38) F			
(1-20) G			
Not environmentally friendly - higher CO ₂ emissions			
England & Wales	EU Directive 2002/91/EC		